

# **AVT Revit Model Features**

1. The model uses a type catalogue so all sizes of the AVT fan range can be inserted using the same .rfa file (see Read Me file attached for further info)

The avt.rfa model attached includes the following options in the Model Properties Category in the Properties Window

Model Properties	
Show Access Clearance	<input checked="" type="checkbox"/>
Atmosphere Side Silen...	1000.0
Room Side Silencer Le...	1000.0
Atmosphere Side Silen...	<input type="checkbox"/>
Room Side Silencer	<input type="checkbox"/>

2. 'Show Access Clearance' allows you to show or hide the access clearance transparent area of the model

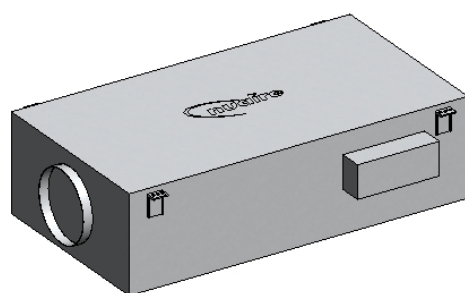
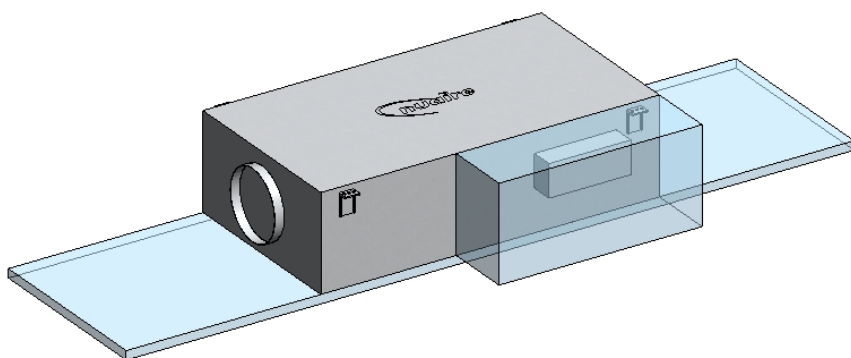
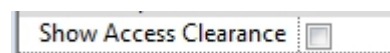
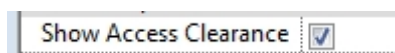

3. You can also choose which matched silencers to use using the tick boxes below. The choice of silencer lengths we offer are: 500mm, 1000mm & 1500mm. Using lengths other than these in the boxes will remove the silencer from both the view and the schedules.

Atmosphere Side Silen...	1500.0
Room Side Silencer Le...	500.0
Atmosphere Side Silen...	<input checked="" type="checkbox"/>
Room Side Silencer	<input checked="" type="checkbox"/>

